

## Clouston Street, Glasgow

For Frank Spratt Ltd (in collaboration with Gholami Baines)

The aim of this urban infill project was to make a distinctive and pleasant place to live which had its own character and fitted into the surrounding urban grain by using a relatively straightforward approach that resonated strongly with the Victorian heritage of Glasgow.

Our concept was to form perimeter blocks which 'complete' the Garioch Road and Sanda/Clouston Street tenements and create a central urban space which is integral with the new built form, responds to the existing line of lime trees on Clouston Street and provides a space which maximises the potential for use. This approach to the urban structure reinforces the existing streets and clearly defines 'fronts' and 'backs' and thresholds.

Within this diagram, the density of occupation was 150+ dwellings, capable of accommodating families and smaller households within a range of flats of differing sizes, including main doors with direct entry from the street as well as terrace houses, and other uses such as small offices / workspaces and a nursery.

The outer perimeter was designed to match the scale of the adjacent tenements with six storeys of accommodation on Sanda Street, dropping to four/five storeys on Kelbourne Street, while the blocks enfronting the new square were 4 storeys high, rising in height and developing 'ends' at Clouston Street to speak to the gables of the adjacent existing tenements.

The aim was to capture the essence of architecture of Victorian Glasgow, without imitating historical details, by careful use of proportion and articulation of window openings, manipulation of solid to void relationships and use of roof forms and high quality materials that resonated with the ashlar fronts and slated pitched roofs of the surrounding buildings. The intention was to continue the Glasgow tradition of creating character and delight by means of local gestures that exploit conditions such as corners, ends, roof lines and surface.

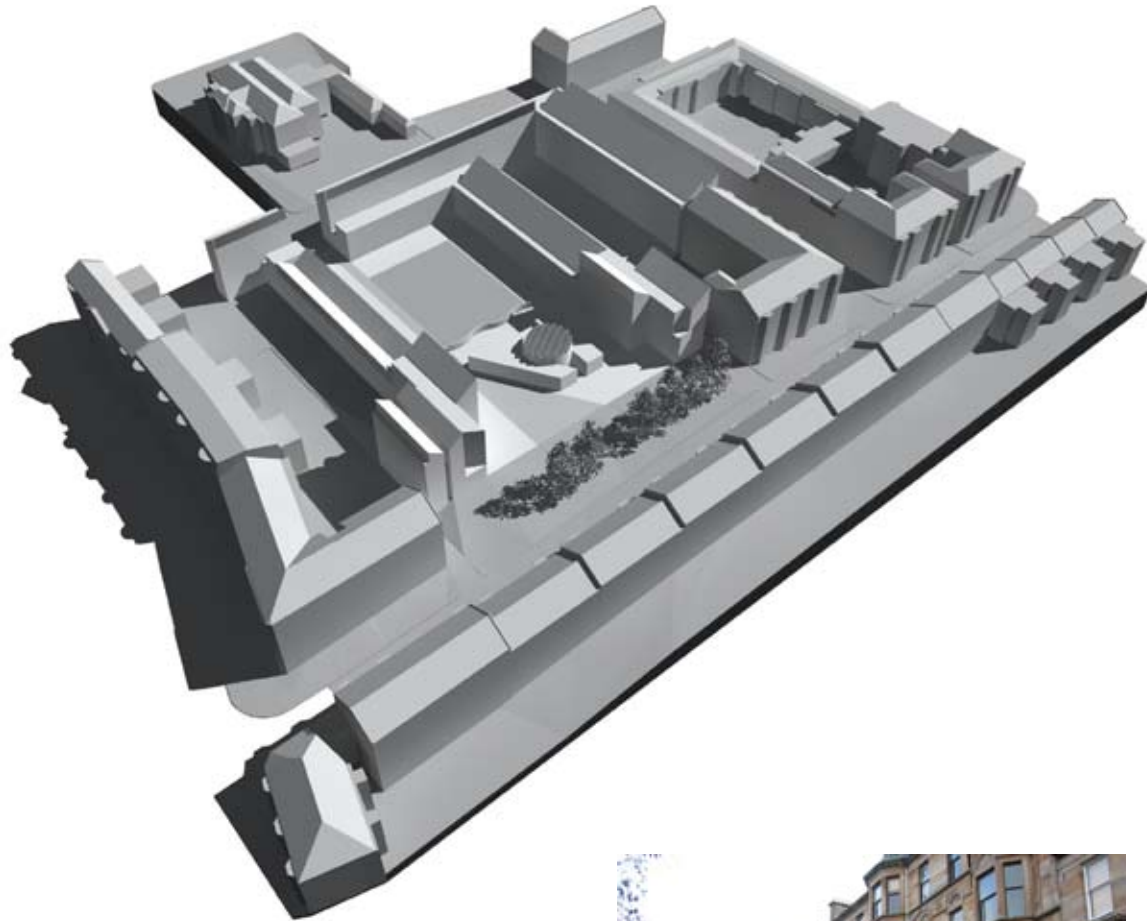

Landscape Architect: Ian White Associates  
Structural Engineer: David Narro Associates  
Services Consultants: Max Fordham Partnership

**ARCADE**  
ARCHITECTS  
[www.arcadearchitects.com](http://www.arcadearchitects.com)